

UNDERLAYMENT SYSTEM SHALL INCLUDE:

- * TYPICAL - ENGLERT HIGH TEMPERATURE (H/T) PEEL & STICK ROOFING UNDERLAYMENT
- * ON METAL DECKING - SELF-ADHESIVE UNDERLAYMENT DESIGNED FOR APPLICATION DIRECTLY ONTO METAL DECKS (e.g., SOPREMA® SOPRAVAP'R VAPOR BARRIER)

APPLIED EITHER:

- * OVER ENTIRE ROOF, or
- * INSTALLED ALONG PERIMETERS (AS SHOWN) w/ ENGLERT SYNTHETIC UNDERLAYMENT ON TOP OVER ENTIRE ROOF

-  RIDGE or HIP 36" (18" EACH SIDE)
-  EAVE or RAKE 36"
-  VALLEY or SLOPE CHANGE 60" (30" EACH SIDE)

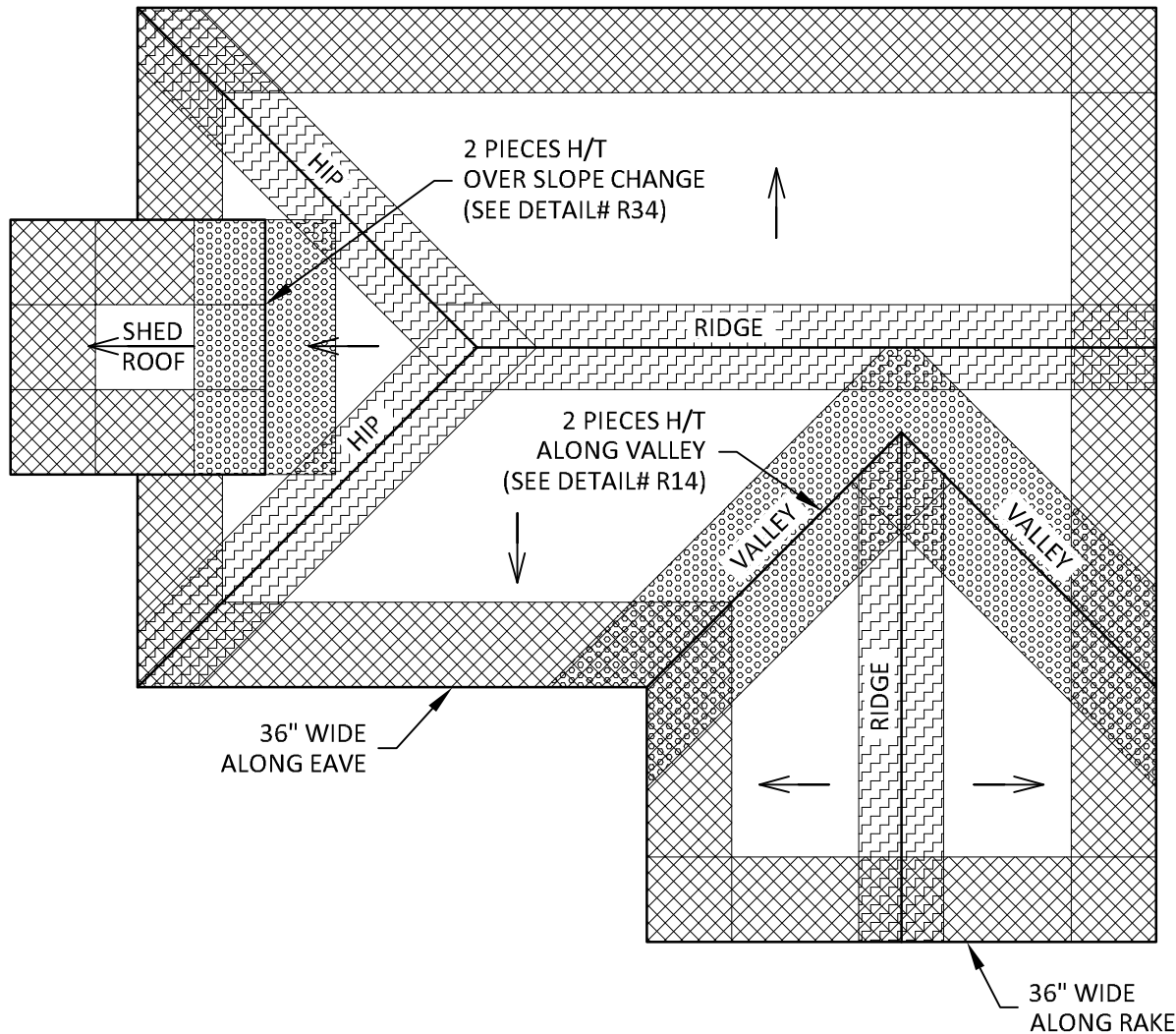

 **ENGLERT™**
 www.englertinc.com
 800-364-5378

FASTENERS & ACCESSORIES

H/T UNDERLAYMENT SYSTEM

DETAIL SUBJECT TO CHANGE WITHOUT NOTICE.

Detail #

R03.3

GENERIC BEST PRACTICE ASSEMBLY SHOWN. WATERTIGHTNESS WARRANTY NOT IMPLIED. WHEN SITE CONDITION DIFFERS, SPECIFIC ENGINEERING NECESSARY.